

GECO CC

342PB01C11



Descrizione del prodotto / Product description

Proiettore LED per interni ed esterni. Ideale per l'illuminazione d'accento o di medie/grandi alberature.

Corpo realizzato da tornitura di alluminio con trattamento superficiale di verniciatura o galvanica rame.

Ottiche ad emissione e schermo in PMMA trasparente.

Pressacavo posteriore IP68.

Sorgente COB LED ad alta resa ed alimentatore IP68 a bordo.

Cavo di collegamento in neoprene. Fornito con connettore a due poli IP68 (vedi istruzioni di montaggio).

LED projector for indoor / outdoor.

Ideal for accent lighting or medium/big trees.

Body made of turning aluminum with painted or copper finish.

Optics made of clear PMMA.

Rear co-printed cable gland IP68.

COB LED source with driver on-board

Neoprene connection cable

Supplied with IP68 connector

(see assembly instructions)

Dati tecnici | Technical Info

* su richiesta / on requests

Finiture | Finishes

- 1032 Rame Naturale | Natural Copper
- 4003 Grafite | Graphite
- 4004 Cemento | Concrete
- 4006 Corten Scuro | Dark Corten
- 4008 Verde Scuro | Dark Green
- 4015 Bianco Fiorentino | Florentine White
- 4024 Rosso Bolgheri | Bolgheri Red
- Verniciati RAL | RAL Paintings*

Potenza | Power 25W

Corrente | Current 700mA

Tensione | Voltage 34 ~ 36V

Tolleranza cromatica | Chromatic tolerance 3 SDCM

Flusso luminoso | Luminous Flux 3000lm

Mantenimento del flusso luminoso | Flux Maintenance ≥50.000h

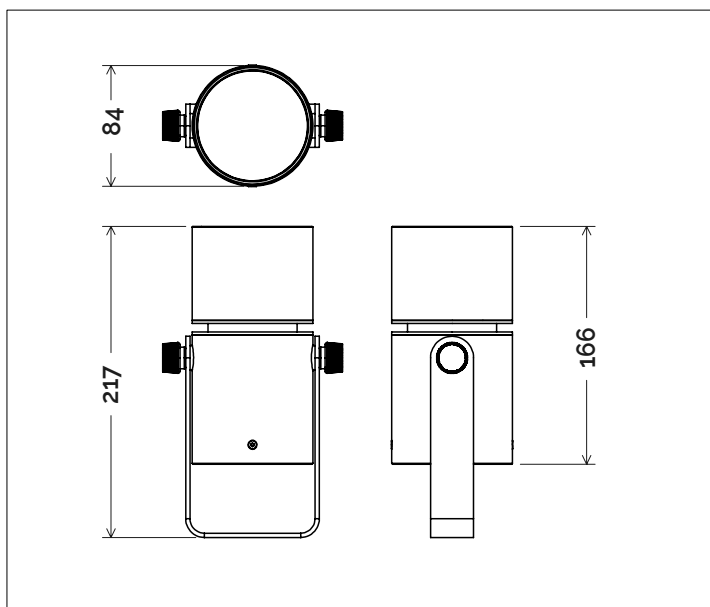

Simbologia tecnica Technical informations

	Conforme alle direttive CE
	Conforme alle normative RoHS
	Classe III
	Indice di Protezione IP65
	Connettore stagno in dotazione

Temperatura di Colore Color Temperature

9027 - 2700K CRI 92
9030 - 3000K CRI 92
9040 - 4000K CRI 92

Ottiche Optics

	M1 -20° (Medium Beam)
	F1 -30° (Flood Beam)
	W3 -50° (Wide Flood Beam)
	W5 -75° (Very Wide Flood Beam)

Sistemi di Controllo Control System

	On / Off (remoto escluso / remote excluded)
	Triac* (remoto escluso / remote excluded)
	Push* (remoto escluso / remote excluded)
	1-10V, 0-10V* (remoto escluso / remote excluded)
	DALI* (remoto escluso / remote excluded)

Creazione Codice | Code construction

342PB01C11-XXXX-XX-XXXX

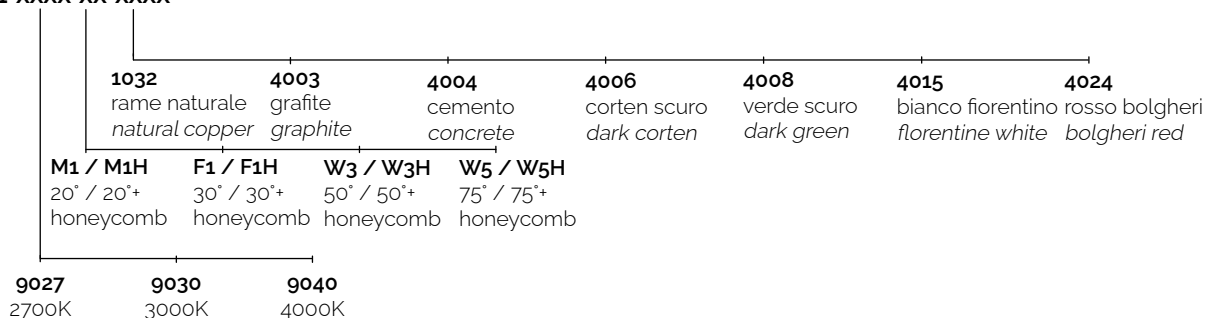

Dati Fotometrici | Photometric Specification

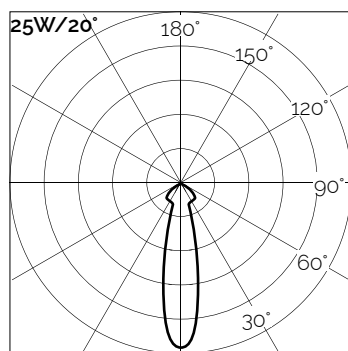

h (m)	E (lx)	D (m)
1	15640	38
1.5	7210	58
2	4390	77
2.5	2530	97
3	1820	116

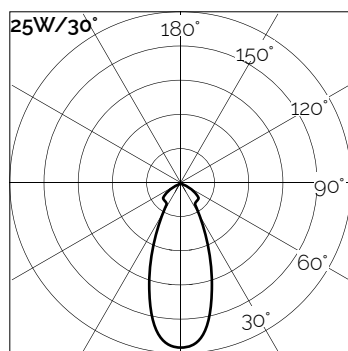

h (m)	E (lx)	D (m)
1	5685	65
1.5	2575	97
2	1436	130
2.5	953	162
3	676	195

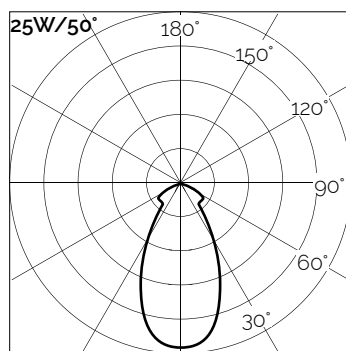

h (m)	E (lx)	D (m)
1	2683	104
1.5	1232	156
2	684	208
2.5	455	260
3	333	312

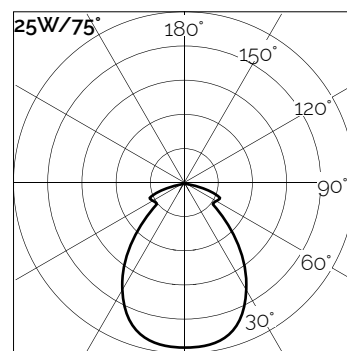

h (m)	E (lx)	D (m)
1	1563	148
1.5	793	221
2	455	296
2.5	305	369
3	226	443

Accessori | Accessories

9C001

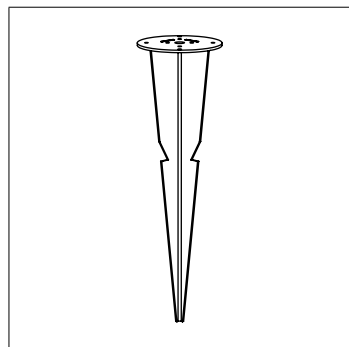

Picchetto per fissaggio a terra.
(Ø70mm H.250mm)

Spike for ground fixing.
(Ø70mm H.250mm)

Alimentatori | *Led*

Tipo Alim. / Driver Type	potenza / power	corrente / current	dimensioni / dimensions	n. prodotti	IP	codice / code
ON/OFF	14W	350mA	38x25x79mm	1	67	gM201
	30W	700mA	38x25x120mm	1	67	gM206
DALI	19~57W	-	35x33x185mm	1	67	gM601